

# 3 INLET VALVE COMPLET WITH FAU- MODEL – 14 & 14 X 7 PHE NL

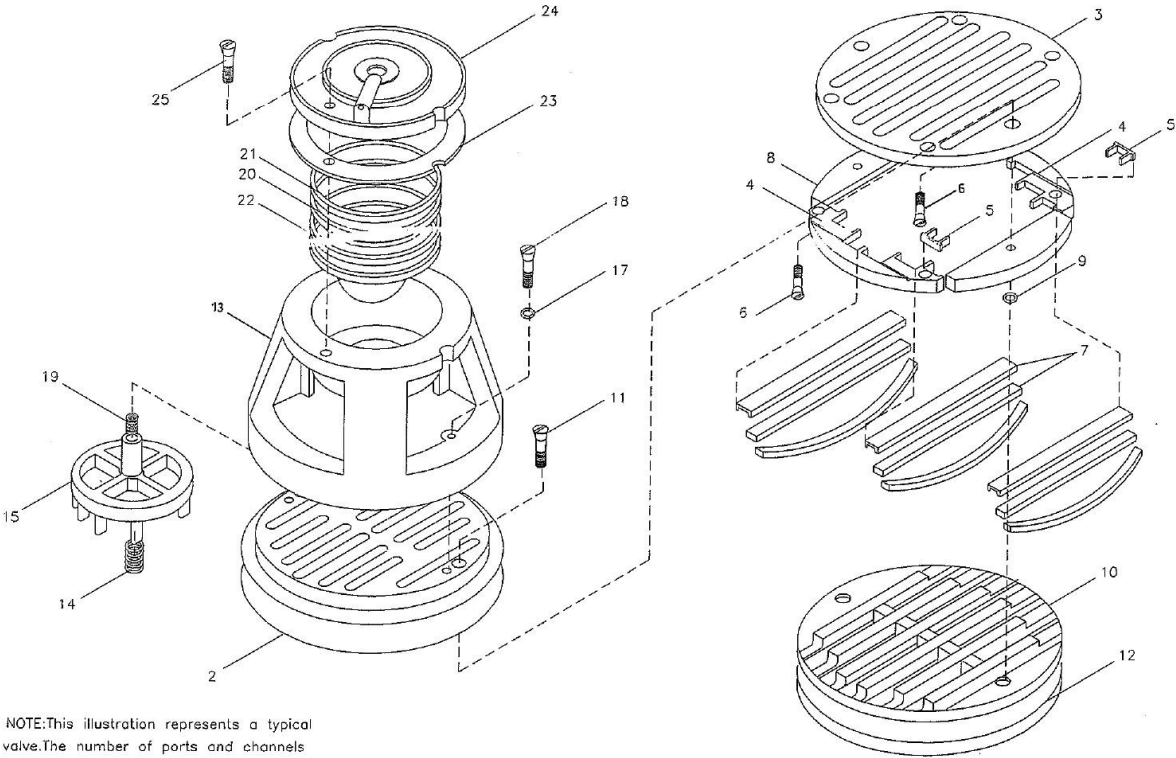

NOTE: This illustration represents a typical valve. The number of ports and channels may vary with the valve size.

## 3 INLET VALVE COMPLET WITH FAU- MODEL – 14 & 14 X 7 PHE NL

Sr.No	Description	Ref Part Nos	Qty
–	. . ASSEMBLY VALVE INLET & FAU A60	<b>70265962</b>	8
–	. . . VALVE INLET A60 150/175# NL	<b>37022100</b>	1
3-2	. . . . SEAT VALVE (IN/DIS)	33046236	1
3-3	. . . . PLATE SEAT A60	17278441	1
3-4	. . . . HOLDER GUIDE	31459027IM	2
3-5	. . . . GUIDE VALVE	37039179IM	14
3-6	. . . . SCREW MACHINE	37025988	4
3-10	. . . . STOP PLATE(IN/DIS) INLET VALVE	30249361	1
3-8	. . . . BALANCER FLOW	37024106	2
3-9	. . . . WASHER BWL	37039377	2
3-7	. . . . CHANNEL & SPRING SET	30515209IM	1
3-11	. . . . SCREW MACHINE	95110599	2
3-12	. . . GASKET VALVE SEAT 20X11	30550628	1
–	. . . ASSEMBLY UNLOADER FAU A60 VALVE NL	<b>70415625</b>	1
3-13	. . . . CAGE UNLOADER 17 19 & 20 CYL	30435085	1
3-24	. . . . COVER INLET UNLOADER IHE 14	97067102	1
3-23	. . . . GASKET UNLOADER COVER	35155613	1
3-25	. . . . SCREW 1/4 X 1-1/8 - FILLISTER HEAD	39322102	2
3-22	. . . . PISTON INLET UNLOADER A60	34054627	1
3-20	. . . . RING PISTON UNLOADER	37103132	2
3-15	. . . . PLUNGER UNLOADER 20X11	30164321	1
3-19	. . . . SPRING UNLOADER PISTON	30576458	1
3-14	. . . . SPRING UNLOADER PLUNGER	30576466	1
3-18	. . . . SCREW MACHINE 1/4IN X 1IN	95001707	2
3-17	. . . . WASHER LOCK 1/4	95081873	2
3-20-37	. . . . SCREW SET 1IN X 1-1/2IN INLET	97073837	1
3-20-36	. . . . NUT SET SCREW	97073860	1
3-20-38	. . . . NUT JAM	95117065	1