

# 4 VALVE INLET COMPLET WITH FAU - MODEL – 12 & 7 X 7 PHE7 NL

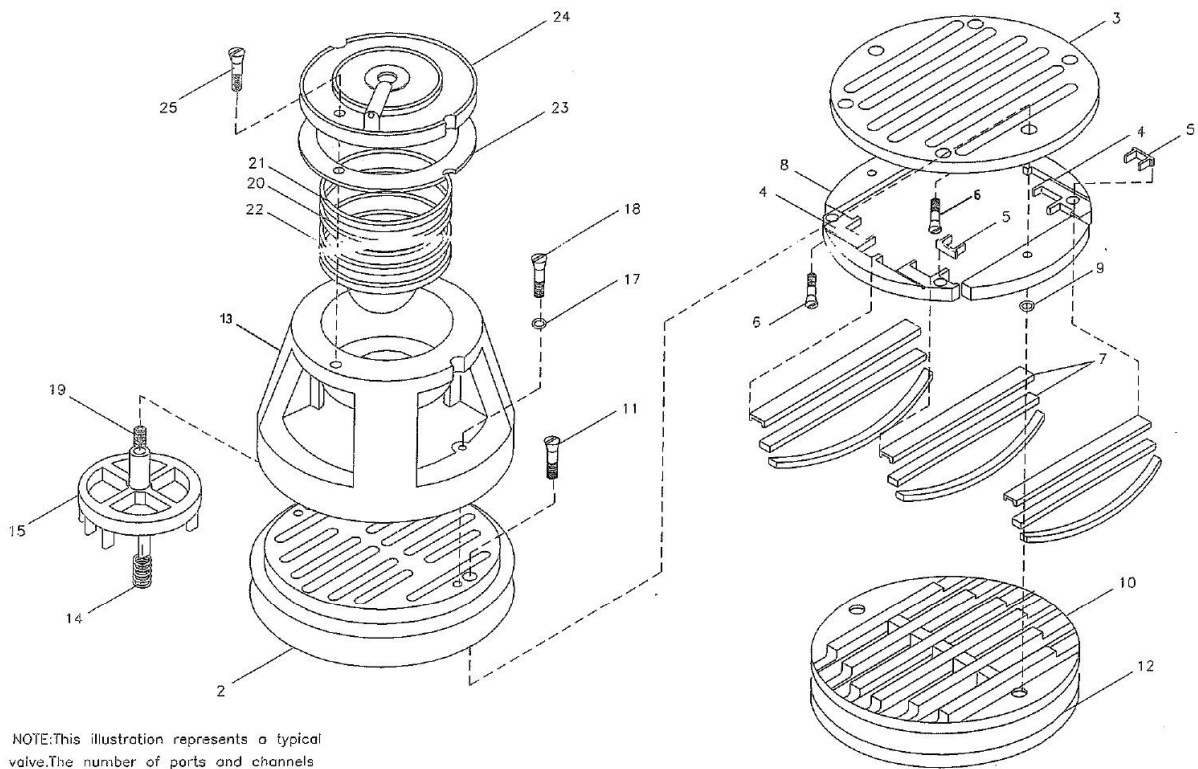

NOTE: This illustration represents a typical valve. The number of parts and channels may vary with the valve size.

# 4 VALVE INLET COMPLET WITH FAU - MODEL – 12 & 7 X 7 PHE7 NL

Sr.No	Description	Ref Part Nos	Qty
–	. . VALVE INLET & FAU-A54	<b>39642939</b>	4
–	. . . VALVE INLET A54 IHE [SPEC-43865]	<b>30405237</b>	1
4-10	. . . . STOP PLATE(IN/DIS) INLET VALVE IHE	30721252	1
4-8	. . . . BALANCER FLOW BARE	37074200	2
4-9	. . . . WASHER BWL	37039377	2
4-7	. . . . CHANNEL & SPRING SET	17287962	1
4-11	. . . . SCREW MACHINE	95110581	2
4-3	. . . . PLATE SEAT A54	17278433	1
4-4	. . . . HOLDER GUIDE 12IHE-NL	37039351IM	2
4-5	. . . . GUIDE VALVE	37039179IM	12
4-6	. . . . SCREW MACHINE	37025988	4
4-2	. . . . SEAT VALVE (IN/DIS) INLET IHE	41029547	1
–	. . . UNLOADER FREE AIR COMPLETE	<b>30529614</b>	1
4-24	. . . . COVER INLET UNLOADER	30250906	1
4-17	. . . . CAGE UNLOADER A54 CHANNEL VLV	30435218	1
4-23	. . . . GASKET COVER FAU	35155712	1
4-22	. . . . PISTON UNLOADER	30162101	1
4-20	. . . . SPRING UNLOADER	30417000	1
–	. . . . RING PISTON UNLOADER	37101474	2
4-16	. . . . PLUNGER FOR A54 CHANNEL VLV	30910186	1
4-15	. . . . SPRING PLUNGER LIFTING	30576490	1
4-25	. . . . SCREW 1/4 X 1-1/8 - FILLISTER HEAD	39322102	2
4-19	. . . . SCREW MACHINE 1/4IN X 1IN	95001707	2
4-18	. . . . WASHER LOCK 1/4	95081873	2
–	. . . GASKET SEAT VLV 18X5	37026556	1